

# PT-FX Shoo-pin™

## FLEX-CABLE COPPER COMPRESSION ADAPTERS

PT-FX Series adapters are designed to terminate high-strand flex-cable (locomotive, mining, welding) to machinery, panels, and transformers. The pins fit mechanical set-screw type connectors and are sized for the current carrying capacity of the cable. These adapters feature the Greaves flared Shoo-in™ barrel-opening design for easy cable insertion. Insulating covers are included.

- ▶ Flared barrel easily gathers flex strands
- ▶ Ideal for termination in set-screw lugs
- ▶ Insulating covers included

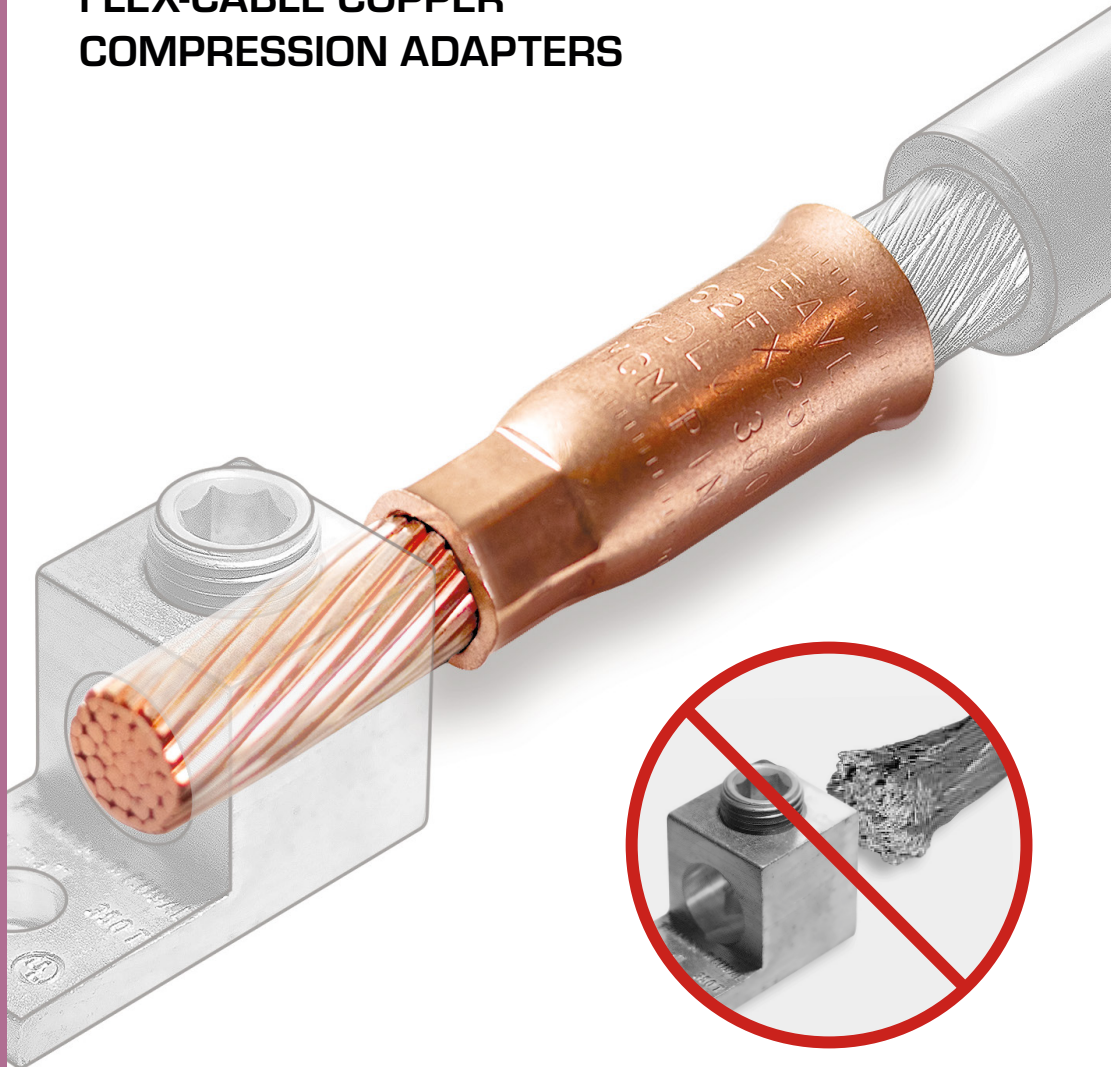

For use wherever flex-cable terminates in a set-screw lug:

- Telecommunications
- Construction Sites
- Drilling Platforms
- Theme Parks
- Locomotive
- Welding
- Marine
- Mining



# GREAVES

[www.greaves-usa.com](http://www.greaves-usa.com)

# PT-FX Shoo-pin™

## FLEX-CABLE COPPER COMPRESSION ADAPTERS

FOR COPPER FLEX-CABLE

600V

105°C

- All-copper compression adapters
- Designed for reliable termination of highly stranded flexible copper cable into mechanical lugs
- Uses include locomotive, mining, marine, and machinery applications
- Features flared Shoo-in™ barrel-opening for easy insertion of fine strands
- Fits into mechanical set-screw type connectors
- Amperage rating is per the incoming conductor
- Fabricated of wrought copper with pin of Class B stranded copper conductor
- Insulating covers are included



Assembled View

### PT-FX SERIES

CATALOG NUMBER	FLEX CABLE OR CODE AWG CONDUCTOR	PIN SIZE	NOMINAL DIMENSIONS (IN)				CABLE STRIP LENGTH	U-TYPE DIE*		
	DLO CABLE (CODE AWG)		B	P	L	D**		COLOR	INDEX	# CRIMPS
PT25FX6†	61/24 (#6)	#6 AWG	1.50	1.06	2.50	0.29	7/8	BLUE	7	1
PT42FX4	91/24-105/24 (#4)	#4 AWG	1.56	1.07	2.63	0.40	1	GRAY	8	1
PT60FX2	125/24-150/24 (#2)	#2 AWG	1.65	1.10	2.75	0.47	1	BROWN	10	1
PT90FX1	175/24-225/24 (#1)	#1 AWG	1.70	1.14	2.75	0.50	1	GREEN	11	1
PT111FX10	275/24 (1/0)	1/0 AWG	1.81	1.23	3.00	0.55	1 1/8	PINK	12	1
PT131FX20	325/24 (2/0)	2/0 AWG	2.06	1.19	3.25	0.61	1 1/4	BLACK	13	1
PT181FX30	450/24 (3/0)	3/0 AWG	2.19	1.30	3.50	0.67	1 1/4	ORANGE	14	1
PT222FX40	550/24 (4/0)	4/0 AWG	2.19	1.31	3.50	0.74	1 1/4	PURPLE	15	1
CATALOG NUMBER	FLEX CABLE ONLY	PIN SIZE	B	P	L	D**	CABLE STRIP LENGTH	COLOR	INDEX	# CRIMPS
PT250FX250	250 kcmil FLEX CLASS G 259 CLASS H 427	250 kcmil	2.25	1.40	3.25	0.78	1 3/8	YELLOW	16	2
PT262FX250	262.6 kcmil FLEX 250 FLEX CLASS I, K, M	250 kcmil	2.20	1.40	3.80	0.81	1 3/8	WHITE	17	2
PT313FX350	313.1 kcmil (775/24) (300 kcmil NOM)	350 kcmil	2.40	1.51	4.00	0.87	1 3/8	RED	18	2
PT373FX350	373.7 kcmil (925/24) (350 kcmil NOM)	350 kcmil	2.75	1.51	4.40	0.99	1 3/8	BLUE	19	2
PT444FX500	444.4 kcmil (1100/24) (450 kcmil NOM)	500 kcmil	3.00	1.75	4.70	1.14	1 3/8	BROWN	20	2
PT535FX500	535.3 kcmil (1325/24) (500 kcmil NOM)	500 kcmil	3.00	1.75	4.85	1.19	1 3/8	GREEN	22	2
PT646FX600	646 kcmil (1600/24) (600 kcmil NOM)	600 kcmil	3.45	1.90	5.50	1.32	2	BLACK	24	2
PT777FX750	777.7 kcmil (1925/24) (750kcmil NOM)	750 kcmil	3.30	2.01	5.50	1.43	2	YELLOW	936	2

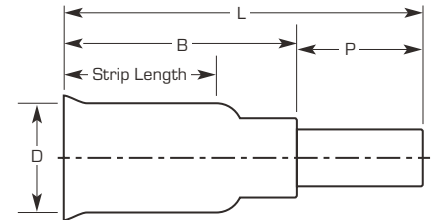

Consult factory for price and delivery of the following:

- DLO sizes 929.2, 1111.1 and larger.
- Custom pin lengths, diameters, and solid pins
- Tin plating (when ordering, add the suffix "P" to catalog number)

\* UL Installation tool: Greenlee HKL 1232

\*\* Add 1/8" for insulating cover

† Size not CSA-certified

Parts with pin lengths up to 12" are UL-rated.

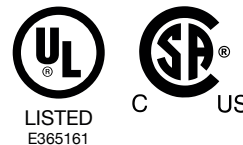

**GREAVES CORPORATION**

P.O. Box 307, Centerbrook, CT 06409

Phone 860-664-4505 | 800-243-1130

www.greaves-usa.com | info@greaves-usa.com

